



**MAT**  
G R O U P

# CATALOG

[www.matgroup.com.tr](http://www.matgroup.com.tr)

We are constructing for the future with continuous innovation and a professional approach.





# CORPORATE

## OUR VISION

*To be one of the best and innovator companies in Turkey and all other countries.*

## OUR MISSION

*To design, plan and fabricate safe, high quality and low cost projects by taking into account the benefits of all employees.*

## OUR VALUES

*All described and documented rules within MAT Group which affiliated, underlie all our activities. We act by considering these rules in each of our projects and works. We are aware that these rules are the way for targets and future.*



# SECTORS



**Activities of MAT Group are generally:**

## **Construction Projects**

*MAT Group is specialized in energy, infrastructure, tank farms, superstructure, pipelines, water projects etc. By collaboration of all group companies turnkey construction are carried out successfully. BTB Construction & Installation is Group's main company for construction projects. Projects are carried from soil to plants and buildings.*

## **Industrial Projects**

*Powerplants, hydroelectric, refineris, petrochemical projects etc are in the scope of MAT Group. MAT Heavy Industry is an material / equipment supplier for Industrial Projects.*

## **Pipeline / Piping / Instrumentation**

*All described and documented rules within MAT Group which affiliated, underlie all our activities. We act by considering these rules in each of our projects and works. We are aware that these rules are the way for targets and future.*

## **Heavy Industry Equipment Fabrication & Installation**

*MAT Heavy Industry is the manufacturing company of MAT Group which is fabricating storage tanks, pressure vessels, heat exchangers, spool, steel structure and tailor made welded fabrications.*

## **International Trade**

*MAT Group is a supplier since more than 10 years for its own worldwide projects. In cooperation with reliable suppliers we are working since years and with our own products, MAT Group is supplying materials and equipments for different sectors.*



# SUBSIDIARIES



**MTRSTEEL**



# MILESTONE

## Brief History of Our Company

Establishment of BTB Construction which is the first company of MAT Group.

July, 2012

January, 2013

First Project in Iraq

Water Supply Infrastructure Project in Georgia.

December, 2013

February, 2016

Steel Construction Works of Romania FORD

First Step to a New Sector: Mechanical Works of Faizabad HEPP / Afghanistan.

April, 2017

July, 2017

Establishment of MAT Pipe, MTR Steel and MAT Heavy Industry.

First Project in Africa: Djibouti Desalination Plant Mechanical Construction.

April, 2019



# BTB' FIELDS OF ACTIVITIES

[www.btb.com.tr](http://www.btb.com.tr)







# SERVICES

---

# STORAGE TANKS

BTB builds storage tanks of all types and capacities, including design, manufacturing, erection, tests and commissioning stages. Our company which completed many different stages of fabrication and erection of storage tank projects in different countries, is also one the Turkey's first 5 API 653 Authorized Inspection Agency.

At every stage of the work related to aboveground storage tanks, the following standards or different international standards are used according to the demands of the customers.

API Std 650  
API Std 653  
API Std 651  
API Std 620  
API Std 652  
ASME Sec V  
ASME Sec IX





# SERVICES

---

# SUPERSTRUCTURE

BTB has successfully carried out superstructure projects in accordance with international quality standards, successful engineering practices and meticulous workmanship that it has always considered.

At every stage of the superstructure works, different standards are used according to the demands of the customers.





# SERVICES

---

# INFRASTRUCTURE

Infrastructure projects is one of BTB's workscope especially in growing countries and geographies. In a wide scope of activities; BTB has completed infrastructure projects from water infrastructure to subway projects.

Our first infrastructure project was, Water Supply Infrastructure project of Kutaisi, Poti, Anaklia cities of Georgia which was started in 2013 and completed in 2015. 8 pumping station / reservoirs, water pipelines, steel structure works, equipment installation works are completed in accordance with international standards and Georgian regulations.





# SERVICES

---

# PIPELINES

Mechanical designs, stress analysis, surge calculations, spool fabrications, site erections and hydrostatic tests of pipelines are in the scope of BTB, which has successfully completed oil pipelines, water pipelines, gas pipelines and process and internal piping of industrial plants.

Some of the international standards used by our expert pipeline teams with international experience are as follows:

- ASME B 31.3
- ASME B 31.4
- API 1104
- API 5L
- ASME Sec IX
- ASME Sec V





# SERVICES

---

## PETROCHEMICAL & ENERGY

All types of equipments, machines, constructions in petrochemical and energy plants are in the scope BTB. BTB as a subsidiary of MAT Group makes cooperation with other Group companies for enlarging the scope in energy projects.

BTB has a long experience about the field from design to commissioning stages.

Some of the plants in scope of BTB:

- Hydropower Plants
- Combined Cycle Power Plants
- Refineries
- Petrochemical Plants
- Detergent Plants
- Food Industry
- Chemical Storage Plants



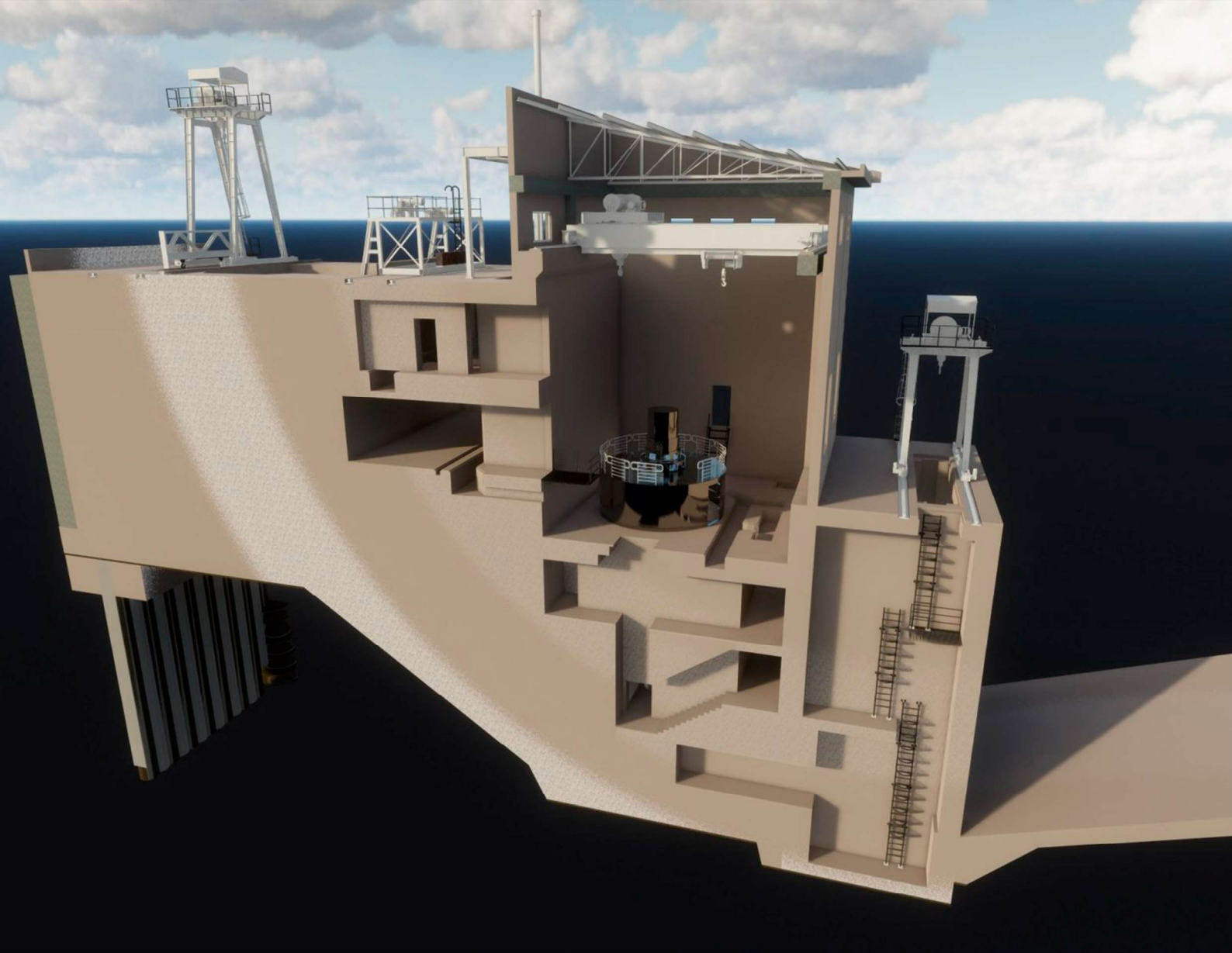

# SERVICES

## WATER PROJECTS

Cognizant about the importance of water projects at the present time of world; BTB is giving special importance to improvements of technologies about water. Infrastructure, waste water treatment, water storage, desalination, dams are some of the scopes which we undertook until today.

With our skilled teams and long term experience; design studies, fabrications, site assemblies are carried out by considering all industrial practices, international standards, regional regulations and customer satisfaction.

BTB has completed water projects in Turkey, Afghanistan, Georgia and Djibouti until today. We believe this experience will carry BTB into the future.

Water Supply Infrastructure  
Waste Water Treatment  
Desalination Plant  
Rehabilitations  
Warning and Monitoring Stations



# MAT HEAVY INDUSTRY'S FIELDS OF ACTIVITIES

[www.matheavyindustry.com](http://www.matheavyindustry.com)







# SERVICES

---

## Storage Tanks

MAT Heavy Industry fabricates storage tanks of all types and capacities, including design, manufacturing, assembly, tests and commissioning stages. Our company which completed many different stages of fabrication and erection of storage tank projects in different countries, is also one of the Turkey's first 5 API 653 Authorized Inspection Agency.

At every stage of the work related to aboveground storage tanks, the following standards or different international standards are used according to the demands of the customers.

- API Std 650
- API Std 653
- API Std 651
- API Std 620
- API Std 652
- ASME Sec V
- ASME Sec IX



# SERVICES

---

## PRESSURE VESSELS

MAT Heavy Industry is full range provider for pressure vessels including design, manufacturing installation, hydrostatic tests, nondestructive tests and QC management for international projects or to support other contractors, MAT Heavy Industry offers technical supervision to ensure safe, efficient, proper installation of products.

Mat Heavy Industry performs all pressure vessel activities in accordance with related international standards. Some of these standards:

- ASME Sec VIII Div. 1
- AD 2000 Merkblätter
- ASME Sec IX
- EN 13445
- API 510
- ASME Sec





# SERVICES

## HEAT EXCHANGERS

MAT Heavy Industry is full range provider for heat exchangers including design, manufacturing installation, hydrostatic tests, nondestructive tests and QC management. for international projects or to support other contractors, MAT Heavy Industry offers technical supervision to ensure safe, efficient, proper installation of products.

Mat Heavy Industry performs all pressure vessel activities in accordance with related international standards. Some of these standards:

- ASME Sec I
- AD 2000 Merkblätter
- ASME Sec IX
- API 510
- ASME Sec V





# SERVICES

---

## PIPING WORKS

MAT Heavy Industry is a full range provider for piping systems including design, manufacturing, installation, hydrostatic tests, nondestructive tests and QC management. MAT Heavy Industry's scope for piping can be process piping for tank farms, chemical industries, petroleum facilities, manifolds at pipelines etc. for international projects or to support other contractors, MAT Heavy Industry offers technical supervision to ensure safe, efficient, proper installation of products.

MAT Heavy Industry performs all piping activities in accordance with related international standards. Some of these standards are:

- ASME B 31.3
- ASME B 31.8
- ASME Sec IX
- ASME B 31.4
- API 1104
- ASME Sec V





# SERVICES

---

## STEEL STRUCTURE

MAT Heavy Industry is carrying out fabrication and installation works of Steel Structure Projects from design to installation stages.

All engineering practices and new developments are followed by MAT Heavy Industry. In our workshops we fabricate steel structure and in case of customer request site installations are carried out by experienced staff.

Some of steel works in scope of MAT Heavy Industry:

- Steel Structure Buildings
- Bridges
- Pumping Stations
- Factories
- Ladders
- Decorative Steel Works





# SERVICES

---

## WELDED FABRICATIONS

Apart from fabrications designed by MAT Heavy Industry, we are making welded fabrications for our Clients as tailor made products.

Upon technical requests from our Clients, we are also making design works by cooperation with the end users.

Some of the fabrications MAT Heavy Industry is fabricating:

Towers and Accessories  
Drums  
Stacks  
Columns  
Driers  
Skids  
Converters  
Autoclavs

Furnaces  
Agitators  
Separators  
Flare Systems  
Feeders  
Conveyors



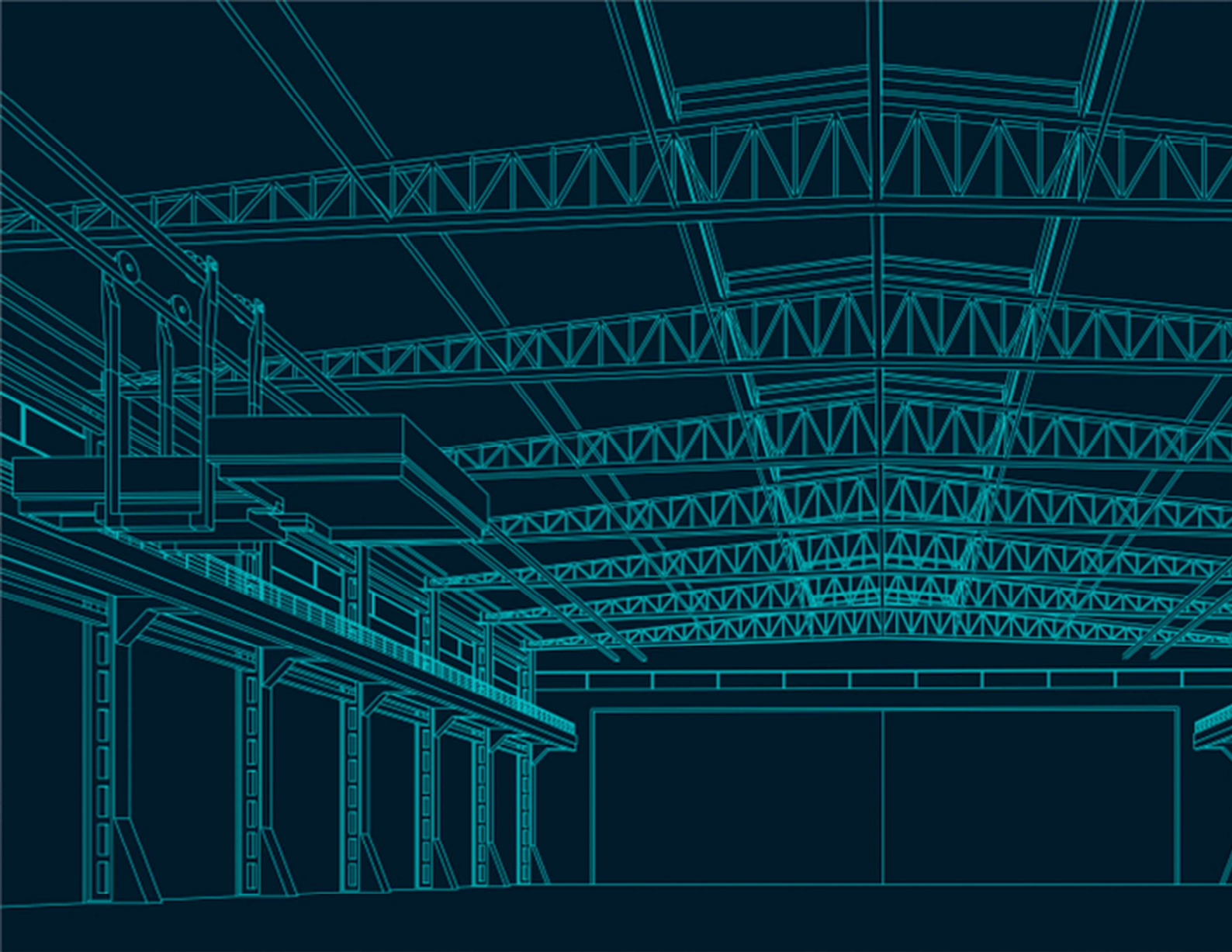

# ENGINEERING

---

# DESIGN

MAT Heavy Engineering specialises in process plant design, procurement, constructions supervising and project management of large scale engineering projects. We provide process plant design engineering expertise throughout all phases of a project. Our areas of expertise are conceptual design, cost estimation and feasibility studies, FEED (front end engineering design), detailed engineering, site construction supervising and commissioning.

Major design standards under practice are ASME (Section I, Section VIII Div. 1 & 2, ASME PVHO-1, ASME B31.1 and ASME B31.3), API650 & API620, TEMA, EN13445, EN14015, EN13385, BS, CEMA, AD Merkblatt & others.

Softwares :

AutoCAD  
PV-Elite  
Compress  
Caepipe  
Caesar

E Tank 2000  
AME Tank  
STAAD-Pro  
ANSYS  
Solid Works





**MTRSTEEL**

# MTR STEEL'S FIELDS OF ACTIVITIES

[www.mtrsteel.com](http://www.mtrsteel.com)







# SERVICES

1

## ENGINEERING

MTR Steel starts structure design from material selection and prepares cost efficient projects and continues to design process until fabrication drawings. The recent developments about engineering are followed and used.

2

## STEEL STRUCTURE FABRICATION

MTR Steel prefabricates steel structures for its Clients. Under favour of better conditions in workshop steel fabrication is advantageous for prefabrication of steel structure.

3

## TURNKEY PROJECTS

MTR Steel is serving to its customers for turnkey steel structure projects. Steel engineering is followed with the analysis, design engineering. After all design studies, we also carry out fabrication and installation steps until the end of tests at site.

4

## MATERIAL SUPPLY

Apart from design, fabrication and installation, MTR Steel provides all kind of steel structure projects. MTR Steel has a wide range of suppliers around world and serves for the best result with its own fabrications and suppliers.

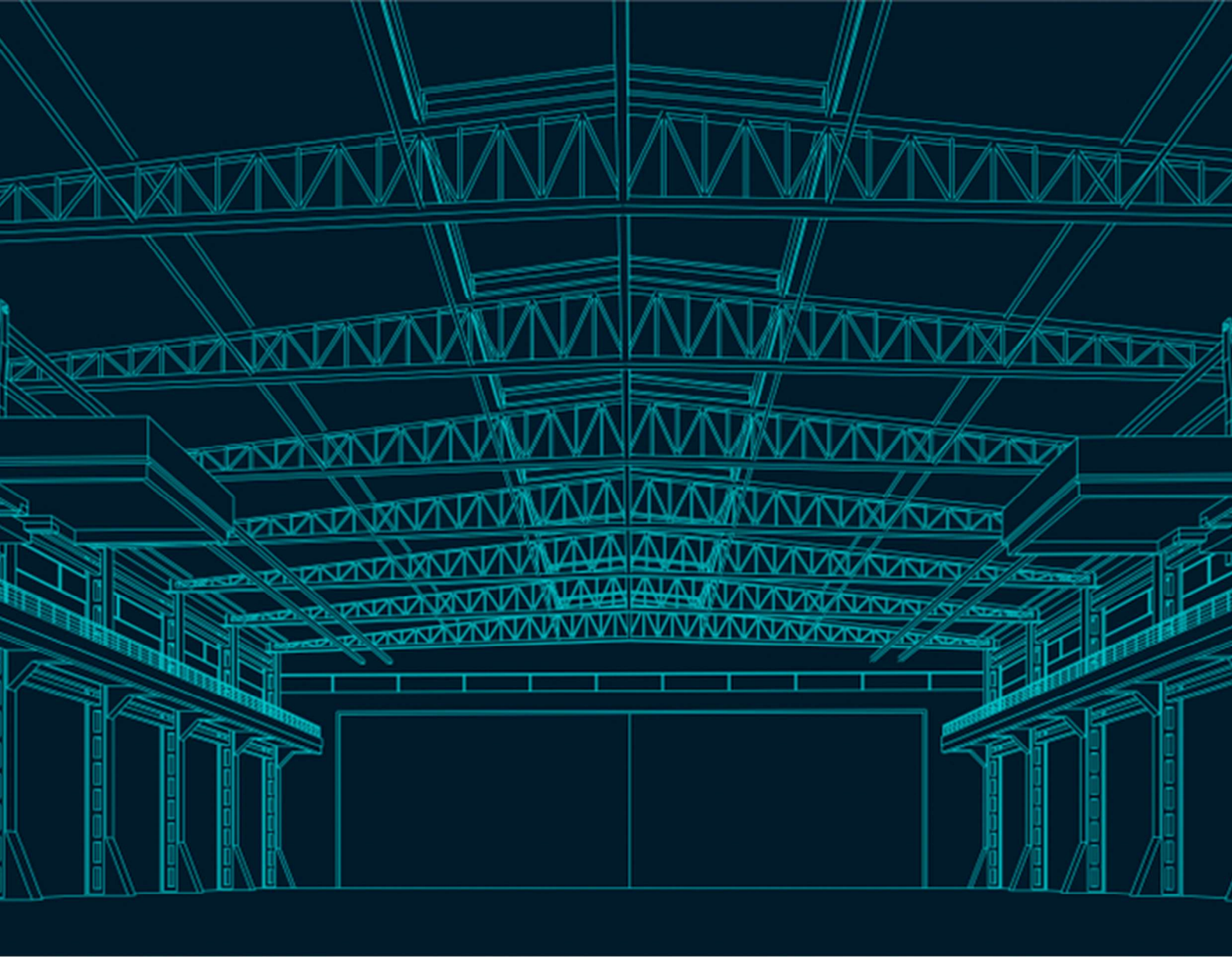

# SERVICES

---

# ENGINEERING

MTR Steel Engineering specialises in steel structure projects, procurement, constructions supervising and project management of large scale projects. We provide design engineering expertise throughout all phases of a project. Our areas of expertise are conceptual design, cost estimation and feasibility studies, FEED (front end engineering design), detailed engineering, site construction supervising and commissioning.

MTR Steel is able make designs in accordance with EN, AWS and GOST Standards.  
Generally used softwares are:

TEKLA

SAP 2000

STAAD PRO





# SERVICES

---

## TURNKEY PROJECTS

MTR Steel is a full range provider for steel structure projects including design, fabrication, installation, tests and QC management.

MTR Steel's scope for steel structure projects can be a small steel work or a huge project.

From beginning to the end of projects MTR Steel works with internationally experienced and skilled personnel and follows international standards and regulations.

MTR Steel performs all steel fabrication in accordance with related international standards and regulations.





# SERVICES

---

## STEEL FABRICATION

MTR Steel is carrying out fabrication and installation works of steel structure projects from design to installation stages.

All engineering practices and new developments are followed by MTR Steel. In our workshops we fabricate steel structure and in case of customer request site installations are carried out by experienced staff.

Some of steel works in scope of MTR Steel:

- Steel Structure Buildings
- Bridges
- Pumping Stations
- Factories
- Ladders
- Decorative Steel Works





# SERVICES

---

## MATERIAL SUPPLY

Apart from design, fabrication and installation, MTR Steel provides all kind of materials about steel structure projects. MTR Steel has a wide range of suppliers around the world and serves for the best result with its own fabrications and suppliers.

MTR Steel always follows the last improvements in engineering and construction sectors to provide best materials for its clients.

All materials supplied by MTR Steel are delivered to customers after a serious control period. Internationally accepted standards are the way to control materials.

On time, safe, best quality deliveries are the most important mottos of MTR Steel.



# MAT PIPE'S FIELDS OF ACTIVITIES

[www.matpipe.com](http://www.matpipe.com)







# SERVICES

1

## PIPELINE ENGINEERING

Mat Pipe starts pipeline design from surge calculation, stress analysis and continues to design process until fabrication drawings. The recent developments about engineering of piping/pipelines are followed.

2

## SPOOL FABRICATION

MAT Pipe prefabricates spools for piping projects. Under favour of better conditions in workshop spool fabrication is advantageous for prefabrication of pipes.

3

## TURNKEY PROJECTS

MAT Pipe is serving to its customers for turnkey piping/pipeline projects. Process engineering is followed with the analysis, design engineering. After all design studies, we also carry fabrication and installation steps until the end of tests at site.

4

## MATERIAL SUPPLY

Apart from design, fabrication and installation, MAT Pipe provides all kind of materials about piping projects. MAT Pipe has a ver wide range of suppliers, around world and serves for the best result with its own fabrications and suppliers.



# SERVICES

---

## PIPELINE ENGINEERING

MAT Pipe is full range provider for piping and pipeline projects including design, fabrication, installation, hydrostatic tests, nondestructive test and QC management. Mat Pipe's scope for piping can be process piping for tank farms, chemical industries, petroleum facilities, manifolds at pipelines.

For international projects or to support other contractos, Mat Pipe offers technical supervision to ensure safe, efficient, proper installation of pipes.

### STANDARDS

All piping/pipeline activities are performed in accordance with related international standards. Some of these standards:

- ASME B 31.3
- ASME B 31.4
- ASME B 31.8
- API 1104
- ASME Sec IX
- ASME Sec V.





# SERVICES

---

## TURNKEY PROJECTS

MAT Pipe is a full range provider for piping systems including design, fabrication, installation, hydrostatic tests, nondestructive tests and QC management.

MAT Pipe's scope for piping projects can be process piping for tank farms, chemical industries, petroleum facilities, manifolds at pipelines, water infrastructure projects, water pumping stations, water reservoirs etc.

From beginning to the end of piping projects MAT Pipe works with internationally experienced and skilled personnel and follows international standards and regulations.

MAT Pipe performs all piping/pipeline activities in accordance with related international standards and regulations..





# SERVICES

---

## SPOOL FABRICATION

Pipe spool fabrication is cutting, beveling, welding of steel pipes, elbows, flanges, fittings etc for pipelines or piping structures.

In workshop conditions, better results can be achieved for pipe welding and prefabrication in compare to site conditions.

MAT Pipe prefabricates pipe spools in accordance with the drawings provided by its Clients or prepared by Mat Pipe.

A wide range of pipe types can be fabricated in MAT Pipe's workshop.





# SERVICES

---

## TURNKEY PROJECTS

MTR Steel is a full range provider for steel structure projects including design, fabrication, installation, tests and QC Management.

MTR Steel's scope for steel structure projects can be a small steel work or a skyscraper.

From beginning to the end of projects MTR Steel works with internationally experienced and skilled personnel and follows international standards and regulations.

MTR Steel performs all steel fabrication in accordance with related international standards and regulations..





# SERVICES

---

## MATERIAL SUPPLY

Apart from design, fabrication and installation, MAT Pipe provides all kind of materials about piping projects. MAT Pipe has a wide range of suppliers around world and serves for the best result with its own fabrications and suppliers.

MAT Pipe always follow the last improvements and in engineering and construction sectors to provide best materials for its clients.

All materials supplied by MAT Pipe are delivered to customers after a serious control period. Internationally accepted standards are the way to control materials.

on time, safe, best quality are the most important mottos of MAT Pipe.





# MAT GROUP'S FLAGSHIP PROJECTS

[www.matgroup.com.tr](http://www.matgroup.com.tr)



# FLAGSHIP PROJECTS



## ***Kabul NATO Base Jet Fuel Pipeline Project***

Jet fuel piping stress analysis And modification in accordance with (ASME B31.1)

Design and stress analysis of jet fuel piping.

Determination of types and locations of supports, pump nozzle stress check tasks are completed.

CLIENT: NSPA / Makro Mechanics

LOCATION: Kabul / AFGHANISTAN

COMPLETED DATE: 2019

## ***Water Infrastructure Project for Kutaisi, Poti, Anaklia Cities of Georgia***

Mechanical works of following pumping stations / reservoirs was completed within the scope of Water Infrastructure Projects of Kutaisi, Poti and Anaklia cities of Georgia:

Kutaisi

Vazha Pshavela Pump Station

Kdiashvili Pump Station

Tetramitsa Su Rezervuari

Vazha Pshavela Temporary Pump Station

Bypass Lines

Poti

Nabada Pump Station

Anaklia

Darcheli Pump Station

MAT Pipe completed the design, fabrication and on-site installation of the piping works, as well as the assembly of all mechanical equipment including pumps.

CLIENT: Grupocobra

LOCATION: Kutaisi / Poti / Anaklia / GEORGIA

COMPLETED DATE: 2013-2015





# FLAGSHIP PROJECTS

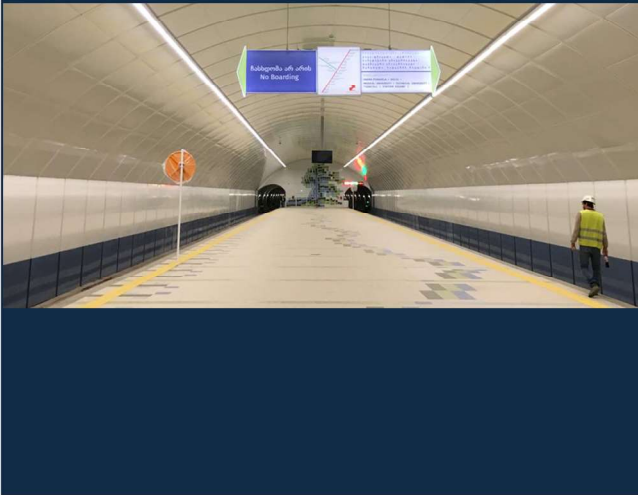

## ***Tbilisi Metro Extension Project***

BTB undertook the construction of mechanical works within the scope of the completion of the Vazha Pshavela Metro Station in Tbilisi, the capital of Georgia .

For the project which was awarded by Grupocobra / Assignia partnership, the mechanical and steel construction works were carried out by our experienced team in Georgia.

This project has particular importance for our company as it is the first metro project experience of BTB.

CLIENT: Grupocobra / Assignia

LOCATION: Tbilisi / GEORGIA

COMPLETED DATE: 2015

## ***82 Km Water Injection Pipeline Basrah / Iraq***

BTB took part as a subcontractor in the project managed by the American Fluor Company and Italian Saipem as the Main Contractor, within the scope of the renovation project of the West Qurna Oil Field in Basra, Iraq and operated by Exxon Mobil.

In this project, which is the first work undertaken by BTB abroad, 82 km of pipeline with 190 bar pressure was constructed.

The reason for the pipeline is to facilitate the drilling of oil by injecting water under the ground at a pressure of 190 bar.

CLIENT: Exxon Mobil / Fluor / Saipem

LOCATION: Basrah / IRAQ

COMPLETED DATE: 2012



# FLAGSHIP PROJECTS

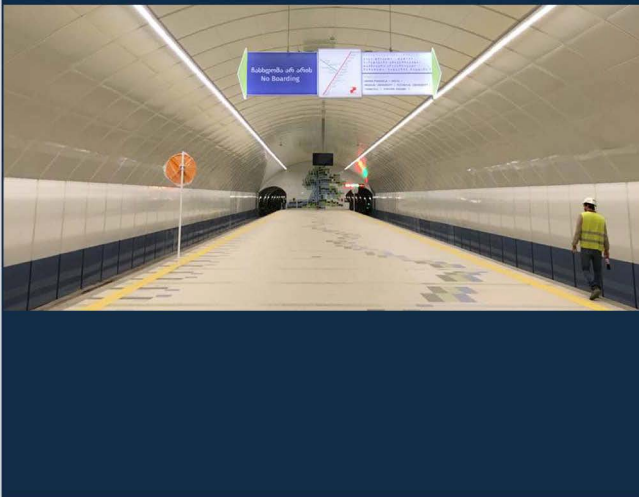

## ***Djibouti Desalination Plant***

MAT Heavy Industry took part in Djibouti Desalination Plant Project with BTB.

Equipment installations such as filters , racks, cranes, pumps are made in the scope of mechanical equipment erection works.

Equipments supplied by the Client Tedagua are installed regarding to project requirements.

CLIENT: Tedagua Djibouti

LOCATION: DJIBOUTI

COMPLETED DATE: 2019

## ***FORD Craiova Steel Construction Fabrication and Installation***

In 2016, BTB carried out a project for the maintenance of FORD Factory in Craiova, Romania for the first time and BTB Romania was established.

Fabrication of steel construction works from raw material supply to painting which was designed by Moncobra company was made in our factory in Istanbul.

After the completion of the delivery of the steel construction parts prepared according to the projects, the assembly was carried out together with the Moncobra company at the FORD factory.

CLIENT: FORD / Romania

LOCATION: Romania

COMPLETED DATE: 2016





# FLAGSHIP PROJECTS

## *Tskaltubo & Telavi Waster Water Treatment Plants*

IMAT Heavy Industry worked on the assembly of all mechanical equipment of the wastewater treatment plants built simultaneously in Tskaltubo and Telavi cities of Georgia, placement of piping, making the system operational, and conducting the tests.

Mechanical parts of the project have been carried out by our company by taking advantage of our previous experiences in Georgia for that project which was all designed by French Sade and Veolia companies. MAT Heavy Industry also carried out the assembly of equipments and steel materials which were fabricated in Turkey with BTB

CLIENT: ADE Georgia & Veolia

LOCATION: Tskaltubo / Telavi / GEORGIA

COMPLETED DATE: 2018-2019





# SUSTAINABILITY

[www.matgroup.com.tr](http://www.matgroup.com.tr)





# SUSTAINABILITY VISION

## SUSTAINABILITY VISION

*"We have been mindful of and diligent about the sustainability-related issues of ethical behaviour, employee welfare, social wellbeing, and environmental health ever since the company's very first day of life."*

*"MAT GROUP's sustainability vision is conceptually embodied in MAT GROUP's motto, 'constructing for the future'. The primary goal of all economic activities is to increase social well-being and to improve the quality of life at the individual and societal level. MAT GROUP's core business activities, including contracting, agri-industry, and investment/service, directly overlap with the basic elements of social welfare, including infrastructure services, food, energy."*



### Strategic Drivers

MAT GROUP's strategic drivers create value, and include climate crisis and energy, employees and society and innovation.

### Enablers

Help make MAT GROUP's constructing for the future vision a reality. Foremost among them include operational excellence, digitalisation, talent management, and occupational health & safety (OHS).

### Operational Roots

Economic performance, corporate governance, and customer loyalty have always been the cornerstones of the company, and will remain so well into the future.



# OUR PRIORITIES

*During the course of the stakeholder dialogue conducted with MAT GROUP's employees, suppliers, clients and vendors, non-governmental organizations and professional associations, the Sustainability Committee, feedback and views of were taken into consideration in order to identify material sustainability issues.*



## Doing Good Business

- Quality of Products and Services
- Economic Performance
- Client Satisfaction
- Ethics and Compliance
- Risk Management



## Developing Communities

- Management of Social, Economic or Environmental Impacts on Local Communities
- Enhance positive impacts
- Social Investment
- Avoid / Mitigate Negative Impacts



## Caring for Employees

- Workplace Health and Safety
- Employee Training and Development
- Employee Rights and Employee Satisfaction
- Diversity, Equal Opportunity and Non-Discrimination



## Reducing Environmental Impact

- Innovation and R&D Work
- Carbon and Water Footprint and Energy Efficiency
- Biodiversity





## SUSTAINABILITY POLICY

1

*As a leading and global company, headquartered in Istanbul, we provide high-quality products and services in any activity we partake in.*

2

*We carry out our business with a corporate management approach that is transparent and accountable and contributes to the vision of sustainable growth.*

3

*We value stakeholder participation. Our comprehensive strategy takes account of stakeholder expectations, lowers risks and helps us establish long-lasting and permanent relationships.*

4

*In addition to ensuring the health and safety of our employees, who are our foremost stakeholders, we provide them with a fair and participatory working environment and invest in their development.*

5

*We support measures against climate change and take care to protect natural resources.*

6

*We contribute to the development and welfare of the countries in which we execute our projects; we ensure our credibility by prioritizing occupational health and safety, quality and cost efficiency.*

7

*We provide employment to thousands of people in geography we operate and help local economies flourish. By meeting regional needs, we contribute in local socio-economic development.*

8

*In all regions where we undertake work, we respect human rights, oppose all forms of discrimination, promote equality of opportunity and expect our business partners to be just as sensitive.*

9

*We measure and assess the environmental and social impact of our activities. We improve processes in place to reduce negative impact.*

10

*We support the development of future generations by investing in education, sports, arts and culture.*



# QUALITY

1

## PLAN EXECUTION

Although it is the road map of the project it is the basic document that defines the whole path to be followed in the project objectives.

2

## QUALITY PLAN

It is the definition of Project Management and all other staff's commitment to quality, methodology and responsibilities to achieve the purpose.

3

## FABRICATION PROCEDURE

It is the written documents created by MTR Stel within its own structure and presented to the staff on how to perform the basic processes.

4

## INSTALLATION PROCEDURE

These are the documents stating how to work for all activities that will continue throughout the project without making the slightest concession from quality and occupational safety requirements.

5

## CONTROL & TEST PLAN

These are the plan and program documents that indicate the conditions under which the controls of our projects will be from the design stage to the manufacturing and assembly stages.

6

## QUALITY TALKS

Before starting each job at factory or worksite, quality meetings are held with all related personnel. At site, daily quality briefings are given by site quality responsible to all team.





# OCCUPATIONAL HEALTH & SAFETY

## **TARGET: “0” ACCIDENT**

***MAT Group’s most important principle is SECURITY. NOTHING IS MORE IMPORTANT THAN THE LIVES OF PEOPLE!***

*In MAT Group, the most important pillar of every step taken is the prevention of accidents. For this purpose, the determination to fully comply with the requirements of the most advanced and latest standards is in no way dispensed with. This commitment applies not only to our employees, but also to suppliers, contractors, collaborating companies and customers. In this direction, MAT Group has established a risk prevention management system in accordance with the requirements of the internationally accepted ISO 45001 standard, and compliance with this management system is regularly checked with internal audits both at the headquarters and in field work at different locations. In each country where we work, the conditions set by that country’s laws are taken into account.*

*One of the main objectives of MAT Group’s general policy is to promote, implement and maintain the occupational risk prevention policy at the highest level of protection for employees in a completely preventive manner and in accordance with the following commitments, in full compliance with the current legislation and our commitments to our customers.*

*Occupational Risk Prevention is managed by Management with a solid and visible commitment and is integrated into all levels of the Organization.*

*All works are carried out in a 100% safe way, in case of doubt or conflict, the work is stopped.*

*Each employee is 100% responsible for Risk Prevention for both himself/herself and his/her colleagues and must actively participate in this process.*

*The proper planning and organization of the daily business, with start-up speeches, is a key factor in Risk Prevention.*

*Communication matrices are the most direct intermediaries for integrating Risk Prevention into daily operation.*

*In addition to follow-up the developments regarding main activities and technology, MAT Group also pays attention to the continuous training and improvement of the personnel.*

***MAT Group’s most important principle is SECURITY. NOTHING IS MORE IMPORTANT THAN THE LIVES OF PEOPLE!***



# ENVIRONMENT

WE AIM TO CREATE VALUES IN ALL FIELDS OF ACTIVITIES WE ARE IN

1

## **"ZERO HARM"**

Our ultimate aim as MAT Group is to cause "Zero Harm" to the environment in all locations where we conduct our operations. To achieve this aim and serve relevant Sustainable Development Goals for a sustainable future.

2

## **PLANNING AND RISK ASSESSMENT**

While we plan our environmental management methodology for each operation, we consider the identified impacts and their mitigation options as a core part of the process.

3

## **"ENVIRONMENTAL IMPACT ASSESSMENT"**

Environmental Impact Assessment sets a baseline for our environmental management system in our operations. During these assessments potential impacts on energy, water, land, air, biodiversity, noise, vibration and natural resources are identified.

4

## **TRAINING, COMPETENCY & CONSULTATION**

We ensure that our employees are competent enough to achieve our ultimate objectives. For this purpose, we work with competent professionals both at corporate offices and in each operation.

5

## **ENERGY MANAGEMENT AND CLIMATE MANAGEMENT**

These are the plan and program documents that indicate the conditions under which the controls of our projects will be from the design stage to the manufacturing and assembly stages.

6

## **WASTE MANAGEMENT**

In respect of our ultimate aim, we use an integrated approach to Waste Management, with our utmost priority being the prevention of waste generation if possible. In cases where it is not possible to do so, other options are chosen by following the steps within the waste hierarchy.





# ENVIRONMENT

## **ENVIRONMENTAL IMPACT ASSESSMENT**

Environmental Impact Assessment sets a baseline for our environmental management system in our operations. During these assessments potential impacts on energy, water, land, air, biodiversity, noise, vibration and natural resources are identified. We apply stringent standards across all our projects, particularly when we operate in critical habitats that are rich in biodiversity and in areas of cultural significance or close to local communities, including indigenous people. All identified impacts are registered through necessary documentation. Mitigations for identified impacts are defined in these assessments and they are included in project planning.



## **PLANNING AND RISK ASSESSMENT**

While we plan our environmental management methodology for each operation, we consider the identified impacts and their mitigation options as a core part of the process. We further combine them with the relevant requirements of prime contract, national and international legislations and standards. Subsequently, we identify the internal and external issues as well as the needs and expectations of our stakeholders which are affected by the environmental management of our operations. The risks and opportunities arising from these issues are evaluated and included during environmental planning. We conduct cradle-to-grave analyses for all our products, services and activities in each operation.



## **TRAINING, COMPETENCY & CONSULTATION**

We ensure that our employees are competent enough to achieve our ultimate objectives. For this purpose, we work with competent professionals both at corporate offices and in each operation. We regularly provide suitable and sufficient amount of training to our employees about environmental related topics including energy management, water management, land management, climate change, pollution prevention, spill prevention, protection of biodiversity, local communities and natural resource consumption. We also provide trainings and awareness meetings to our relevant stakeholders about environmental topics related to them. Consultation on environmental topics with stakeholders is one of the main principles of our management system.





# ENVIRONMENT

## ENERGY MANAGEMENT AND CLIMATE MANAGEMENT

Energy management is a key element for us to execute our work. We always seek for the most efficient energy systems with the best available technology. We analyze our current systems, keep track of efficiency opportunities and integrate improvements if applicable. In addition, we make investments on renewable energy resources where feasible.

In today's world, energy has become a basic human need and a necessity which our lives depend on. Due to a globally growing population, energy demand increases every day while the current state of our planet and the climate face serious threats.

We are aware of the fact that the climate is changing and we should take responsibility to do our part to leave a better habitat for future generations. As part of our environmental management system, we measure our greenhouse gas emissions and calculate our carbon footprint annually in accordance with international accepted standards. We report our climate strategy and greenhouse gas (GHG) emissions data on international platforms and the public transparently.



## WASTE MANAGEMENT

In respect of our ultimate aim, we use an integrated approach to Waste Management, with our utmost priority being the prevention of waste generation if possible. In cases where it is not possible to do so, other options are chosen by following the steps within the waste hierarchy. Waste Management Plans are developed for each operation in light of impact assessments which aim to 'Eliminate Waste at Source'. Then Reduce, Reuse, Recycle principles are applied to manage the waste and minimize the impact of wastes. Finally, proper waste disposal methodologies are followed. We are keen to reduce plastic waste by banning the use of plastic bottles and replacing plastic products with alternatives.





# ENVIRONMENT

## COMPLIANCE WITH INTERNATIONAL STANDARDS

Our Environmental Management System is in full compliance with the ISO 14001:2015 Environmental Management Systems Standard. As a result of the most recent audits, we have successfully completed our transition to the latest 2015 revision of the ISO 14001 Standard.

## ENVIRONMENTAL EMERGENCY & INCIDENT MANAGEMENT

We plan, prepare and test our emergency response to environmental emergencies and incidents. We consider environmental incidents as opportunities to determine their causes and make sure they never happen again. For this purpose, we investigate and report each and every environmental incident, no matter its magnitude, in great detail. The lessons we learn following the investigation process are shared with all project management and execution groups as well as corporate management to make sure necessary measures are taken at all levels of the company.



## ENVIRONMENTAL PERFORMANCE MONITORING

We set smart targets and key performance indicators for each of our operations and measure our actual performance against them. Improvement plans are prepared and implemented where there is a gap between the target and actual performance. We report our environmental performance to stakeholders, interested parties and the public transparently.

## ENVIRONMENTAL AUDITS

We regularly conduct internal environmental audits in each operation to ensure we comply with relevant requirements. Subcontractor and supplier (i.e. vendor) operations are also included in our audits. For each subcontractor and supplier, a preliminary environmental survey is conducted in the course of vendor selection process and at the commencement of operations. For each selected vendor, follow-up-audits are performed during the subsequent steps of operations. Environmental performance is a criteria in subcontractor / supplier performance evaluation process.



# SUSTAINABILITY AIMS

## MANAGEMENT REVIEW

*To achieve continual improvement of our system, we review the management system and our environmental performance annually in detail, identify the improvement areas and take appropriate actions in a timely manner.*





# COMPLIANCE



## ETHICS & COMPLIANCE

### **INTEGRITY**

Our conduct towards our clients, shareholders, employees, suppliers, subcontractors, government and regulatory authorities, competitors and towards society as a whole is without fault.

### **SOLIDARITY**

Sharing success and standing together in the face of failure

### **TRUST**

An open relationship with our employees based on mutual trust, respect and success.

### **COMMITMENT**

Uncompromising commitment to Quality, Health, Safety and Environment

### **ETHICS**

Transparency, Accountability and Discipline in our business

### **INNOVATIVE ACUMEN**

Excellence, Innovation and Improvement

### ***MAT Geoup's Business Conduct includes the following twelve components:***

- Respect for Human Rights
- Diversity and Inclusion
- Harassment-Free Workplace
- Freedom of Association and Collective Bargaining
- Safe and Healthy Workplace
- Workplace Security
- Preventing Child Labor, Forced Labor and Human Trafficking
- Social Community Engagement
- Fair Employment Practices
- Employee Personal Information
- Guidance and Reporting for Employees
- Suppliers



# COMMUNITY INVESTMENT

## ***SOCIAL INVESTMENT***

MAT GROUP through its core business activities contributes to the development and welfare of the countries in which it operates, with the aim to create a positive and enduring presence and leave a positive legacy on the communities and societies.

MAT GROUP has Social Community Engagement procedure aligned with the company's Sustainability Policy, the objective of which is to enhance the delivery of social community engagement on the ground that is supporting the achievement of its business goals.

The scope of social community related activities which need to be managed properly throughout all operations in order to reach intended deliverables are listed below:

## ***SOCIAL WELFARE***

The social, cultural, and environmental wellbeing efforts in which MAT GROUP has been engaged since its inception are essential elements of its corporate culture. Mindful of putting some of the value that it creates to work in socially beneficial projects, MAT GROUP undertakes a variety of corporate social responsibility projects under the headings of "Education", "Culture & Art", and "Sustainable Development".

These activities shall be managed properly throughout all operations in order to reach intended deliverables, listed below, regarding Social Community Engagement:

- An improved understanding of the range of an operation's stakeholders, their perceptions of the operation and how they relate to each other
- An improved understanding of the operation's positive and negative impacts, leading to improved management of both
- Improved risk management
- Increased local stakeholder understanding of the contribution which the operation makes to the local community and, perhaps, of some constraints faced by the operation
- A more structured plan and key performance effectively managing impacts, indicators for engaging with local communities going forward, effectively managing impacts as well as for contributing to their sustainable social and economic development
- Leave a positive legacy.

### **ENHANCE POSITIVE**

- Revenues      - Taxes
- Employment   - Procurement
- Local Content
- Shared Infrastructure
- Technology and Skills Transfer

### **SOCIAL INVESTMENT**

- Community Capacity Development
- Enterprise Development
- Education (e.g., Scholarship)
- Environmental Improvement
- Targeted Donations

### **AVOID / MIGRATE NEGATIVE IMPACTS**

- Resettlement & Livelihood
- Workforce Impacts
- Traffic Management
- Noise Management
- Indigenouns People
- Cultural Heritage







Adres :19 Mayıs Mah. İnönü Cad. Sumer Sok.  
Zitas Sitesi D-1 D.8  
Tel : +90216 3505200  
Eposta : info@matgroup.com.tr  
Web : www.matgroup.com.tr

